

LUMAC
ELEVATE LIFE

BUILDER PROFILE

AS A PARTNER AT LUMAC REALTECH, HE HAS BEEN INSTRUMENTAL IN CREATING TRANSFORMATIVE AND VALUE-DRIVEN DEVELOPMENTS. HIS LEADERSHIP IS DEFINED BY VISION, INTEGRITY, AND THE ABILITY TO INSPIRE TEAMS TOWARD EXCELLENCE. WITH OVER 16 YEARS OF EXPERIENCE IN REAL ESTATE, HARRY KOHRI SPECIALIZES IN LAND CONSOLIDATION, STRATEGIC PLANNING, AND CONCEPT-DRIVEN DEVELOPMENTS HIS VISION IS TO TRANSFORM LAND INTO ENDURING LANDMARKS THROUGH INNOVATION, SUSTAINABLE GROWTH, AND SOUND BUSINESS STRATEGY.



HARMANJEET
SINGH KHORI



VARUN JAIN

VARUN JAIN, FOUNDER OF KKJ GROUP AND RATNAKAR GROUP, IS A VISIONARY LEADER IN THE REAL ESTATE INDUSTRY, BLENDING HIS PASSION FOR DESIGN WITH STRONG BUSINESS ACUMEN. HIS STRATEGIC VISION FOCUSES ON IDENTIFYING HIGH-POTENTIAL URBAN LOCATIONS, DRIVING INNOVATION, AND CREATING LONG-TERM VALUE. COMMITTED TO SUSTAINABILITY AND RELIABILITY, VARUN CONTINUES TO SHAPE THE FUTURE OF REAL ESTATE WITH A FOCUS ON TECHNOLOGY, SMART CITIES, AND TRUST-DRIVEN GROWTH.

SEAMLESS CONNECTIVITY

- AERO CITY- 1 MIN
- FORTIS HOSPITAL
- AMITY UNIVERSITY
- HDFC BANK
- IT CITY - 0 MIN
- INFOSYS
- PLAKSHA UNIVERSITY

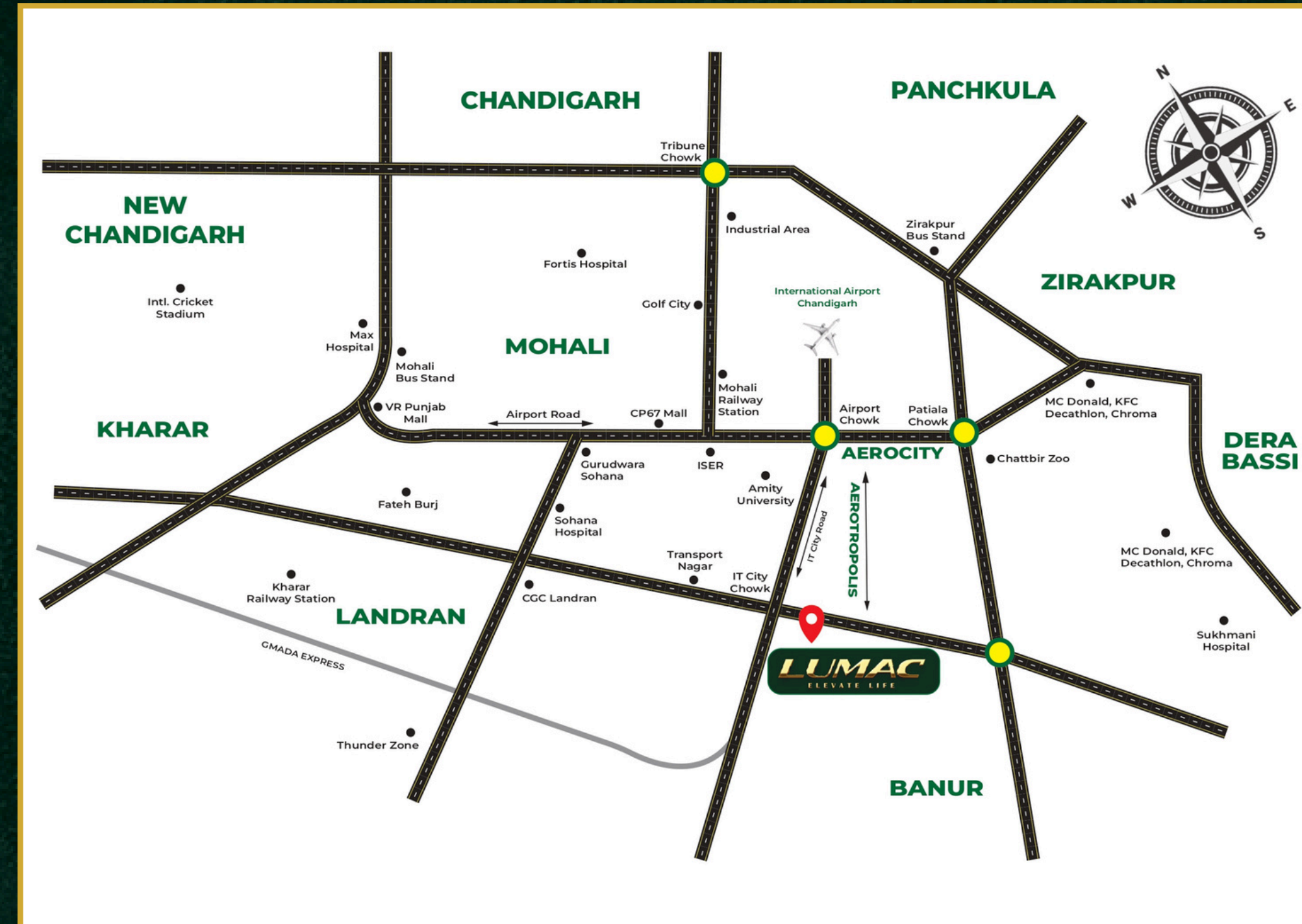

LOCATED IN SECTOR 102, ONE OF MOHALI'S
FASTEST-GROWING AND MOST PROMISING SECTORS,



ABOUT US

MOHALI CREST IS A PREMIUM RESIDENTIAL PROJECT BY LUMAC. THE PROJECT IS SPREAD ACROSS 6.25 ACRES OF LAND AND COMPRISES 5 RESIDENTIAL TOWERS WITH 3+1 BHK AND 4+1 BHK LUXURY APARTMENTS. MOHALI CREST IS LOCATED NEAR IT JUNCTION. MOHALI IS A RAPIDLY GROWING AREA AND IS EXPECTED TO BE THE NEXT BIG DESTINATION FOR REAL ESTATE DEVELOPMENT IN THE REGION. MOHALI CREST OFFERS A HOST OF AMENITIES SUCH AS CLUBHOUSE, SWIMMING POOL, GYMNASIUM, LANDSCAPED GARDENS, CHILDREN'S PLAY AREA, JOGGING TRACK AND LOT MORE. THE PROJECT OFFERS APARTMENTS IN VARIOUS SIZES. THE APARTMENTS ARE DESIGNED TO PROVIDE AMPLE NATURAL LIGHT AND VENTILATION.



SITE PLAN

MOHALI CREST IS A PREMIUM RESIDENTIAL PROJECT BY LUMAC. THE PROJECT IS SPREAD ACROSS 6.25 ACRES OF LAND AND COMPRISES 5 RESIDENTIAL TOWERS WITH 3+1 BHK AND 4+1 BHK LUXURY APARTMENTS. MOHALI CREST IS LOCATED NEAR IT JUNCTION. MOHALI IS A RAPIDLY GROWING AREA AND IS EXPECTED TO BE THE NEXT BIG DESTINATION FOR REAL ESTATE DEVELOPMENT IN THE REGION. MOHALI CREST OFFERS A HOST OF AMENITIES SUCH AS CLUBHOUSE, SWIMMING POOL, GYMNASIUM, LANDSCAPED GARDENS, CHILDREN'S PLAY AREA, JOGGING TRACK AND LOT MORE. THE PROJECT OFFERS APARTMENTS IN VARIOUS SIZES. THE APARTMENTS ARE DESIGNED TO PROVIDE AMPLE NATURAL LIGHT AND VENTILATION.



PROJECT DETAIL (3+1BHK)

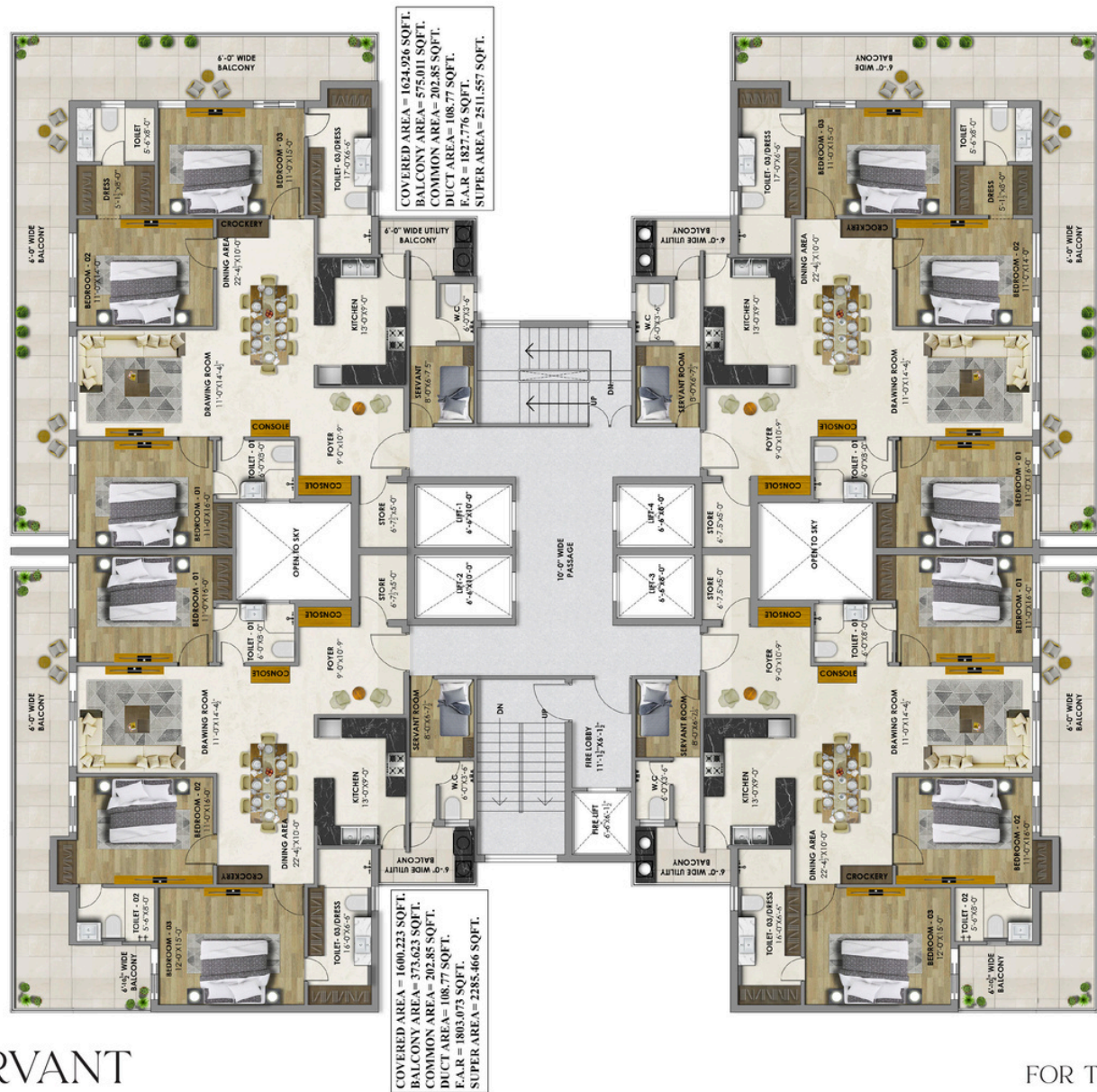

3BHK+SERVANT

FOR TRAINING PURPOSE



PROJECT DETAIL (4+1BHK)



4BHK+SERVANT

FOR TRAINING PURPOSE



AMENITIES

- 24X7 DOCTOR AVAILABILITY
- 24X7 POWER BACKUP
- EV CHARGING STATION
- EMERGENCY 24X7
- SPA & WELLNESS CENTER
- 5 STAR CLUBHOUSE
- PRIVATE CINEMA HALL
- YOGA STUDIO
- SWIMMING POOL
- LIBRARY
- CRECHE
- SALON
- GYM



24×7 DOCTOR AVAILABILITY

Your Health, Our Priority

OUR GOAL IS TO PROVIDE PEACE OF MIND AND A SAFE LIVING ENVIRONMENT FOR ALL RESIDENTS, ENSURING THAT IMMEDIATE MEDICAL CARE IS ACCESSIBLE AT ANY HOUR OF THE DAY OR NIGHT. AT LUMAC MOHALI CREST, WE PRIORITIZE THE WELL-BEING OF OUR RESIDENTS BY ENSURING ROUND-THE-CLOCK DOCTOR AVAILABILITY WITHIN THE PREMISES. WHETHER IT'S A MINOR HEALTH CONCERN OR AN UNEXPECTED EMERGENCY, PROFESSIONAL MEDICAL ASSISTANCE IS ALWAYS JUST A CALL AWAY.

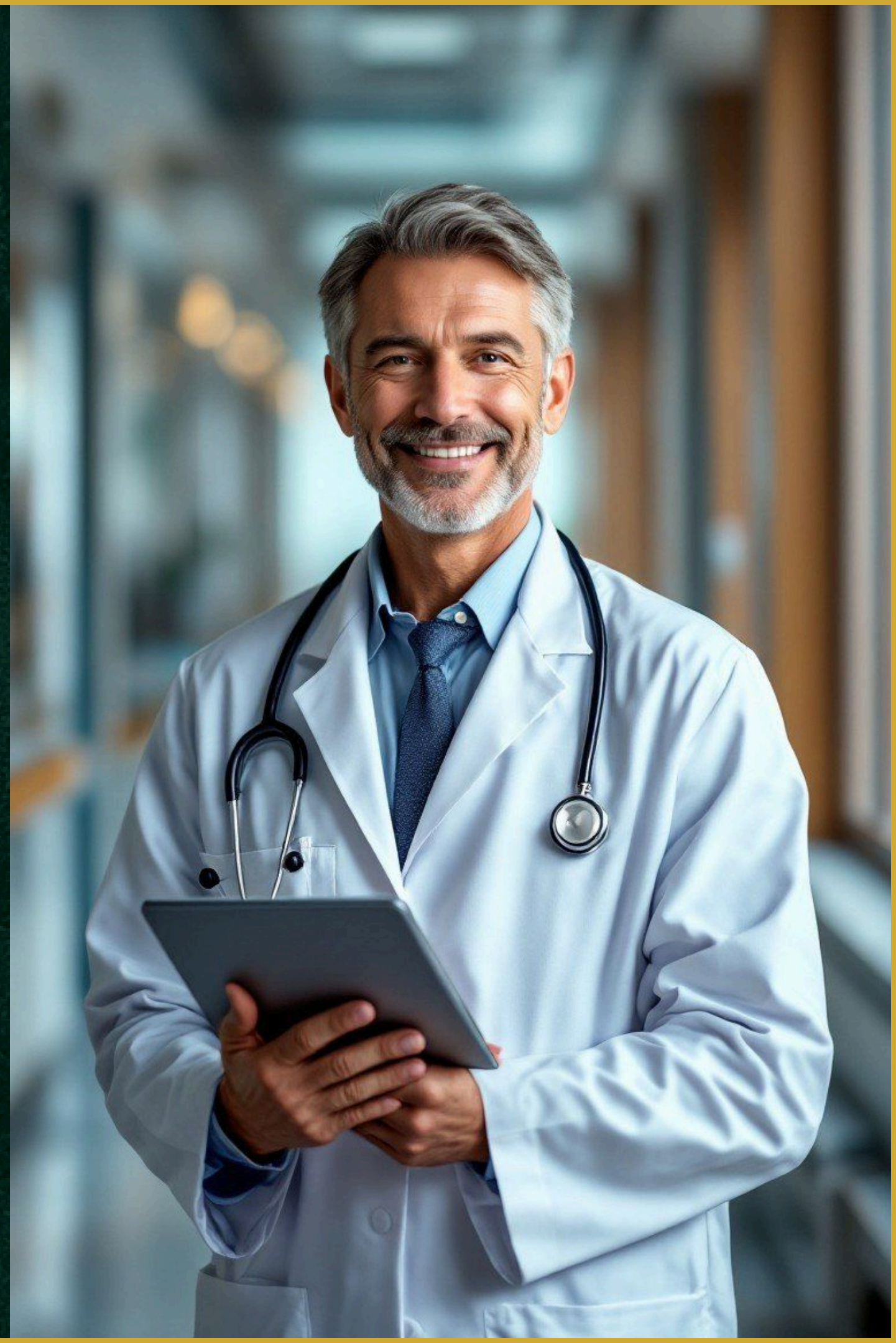

24X7 POWER BACKUP

Uninterrupted Living, Always Powered

EXPERIENCE TRUE COMFORT AND CONVENIENCE WITH OUR RELIABLE 24X7 POWER BACKUP SYSTEM THAT ENSURES YOUR HOME AND COMMUNITY REMAIN FULLY POWERED AT ALL TIMES. NO MATTER THE HOUR OR THE WEATHER, YOU CAN ENJOY SEAMLESS ELECTRICITY WITHOUT ANY DISRUPTIONS TO YOUR DAILY ROUTINE. FROM ESSENTIAL HOUSEHOLD NEEDS TO MODERN AMENITIES, EVERY CORNER OF YOUR SPACE STAYS BRIGHT, FUNCTIONAL, AND CONNECTED. THIS CONTINUOUS POWER SUPPLY GUARANTEES PEACE OF MIND AND UNINTERRUPTED LIVING — SO YOU CAN FOCUS ON WHAT TRULY MATTERS WITHOUT WORRYING ABOUT POWER CUTS OR DOWNTIME.



EV CHARGING STATION

Future-Ready with EV Charging Points

EMBRACE SUSTAINABLE LIVING WITH OUR STATE-OF-THE-ART ELECTRIC VEHICLE (EV) CHARGING STATIONS, THOUGHTFULLY INTEGRATED WITHIN THE PREMISES FOR YOUR CONVENIENCE. DESIGNED TO SUPPORT THE GROWING SHIFT TOWARD CLEAN AND GREEN MOBILITY, THESE CHARGING POINTS MAKE POWERING YOUR ELECTRIC VEHICLE EFFORTLESS AND TIME-EFFICIENT. WHETHER YOU'RE RETURNING HOME AFTER A LONG DAY OR PREPARING FOR YOUR NEXT JOURNEY, YOU CAN EASILY CHARGE YOUR VEHICLE IN A SAFE, SECURE, AND ACCESSIBLE ENVIRONMENT. BY PROVIDING MODERN EV INFRASTRUCTURE, WE ENSURE THAT OUR COMMUNITY STAYS FUTURE-READY WHILE CONTRIBUTING TO A CLEANER, GREENER PLANET.



EMERGENCY 24X7

Round-the-Clock Emergency Assistance

YOUR SAFETY AND PEACE OF MIND ARE OUR UTMOST PRIORITY. OUR COMMUNITY IS EQUIPPED WITH A DEDICATED 24X7 EMERGENCY RESPONSE SYSTEM, SUPPORTED BY TRAINED STAFF WHO ARE ALWAYS READY TO ASSIST IN ANY SITUATION. WHETHER IT'S A MEDICAL ISSUE, SAFETY CONCERN, OR UNEXPECTED INCIDENT, HELP IS AVAILABLE INSTANTLY — ENSURING THAT YOU AND YOUR LOVED ONES ARE NEVER ALONE IN TIMES OF NEED. WITH CONSTANT VIGILANCE AND RAPID RESPONSE PROTOCOLS IN PLACE, YOU CAN LIVE CONFIDENTLY KNOWING THAT PROFESSIONAL ASSISTANCE IS JUST MOMENTS AWAY, ANY HOUR OF THE DAY OR NIGHT.



SPA & WELLNESS CENTER

Relax, Rejuvenate & Recharge

YOUR SAFETY AND PEACE OF MIND ARE OUR UTMOST PRIORITY. OUR COMMUNITY IS EQUIPPED WITH A DEDICATED 24X7 EMERGENCY RESPONSE SYSTEM, SUPPORTED BY TRAINED STAFF WHO ARE ALWAYS READY TO ASSIST IN ANY SITUATION. WHETHER IT'S A MEDICAL ISSUE, SAFETY CONCERN, OR UNEXPECTED INCIDENT, HELP IS AVAILABLE INSTANTLY — ENSURING THAT YOU AND YOUR LOVED ONES ARE NEVER ALONE IN TIMES OF NEED. WITH CONSTANT VIGILANCE AND RAPID RESPONSE PROTOCOLS IN PLACE, YOU CAN LIVE CONFIDENTLY KNOWING THAT PROFESSIONAL ASSISTANCE IS JUST MOMENTS AWAY, ANY HOUR OF THE DAY OR NIGHT.

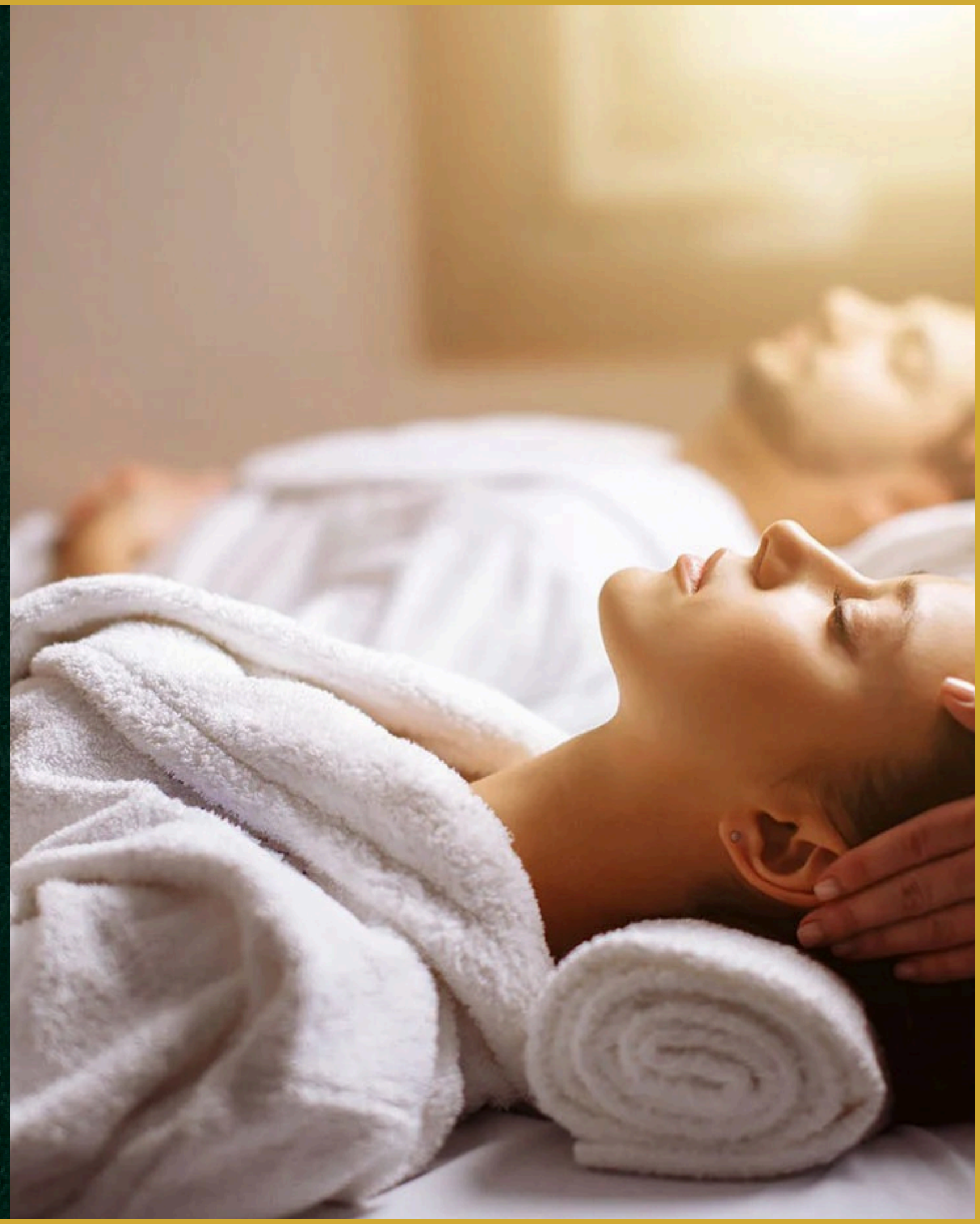

GREEN PARK RESIDENCES

Luxury Homes Surrounded by Nature's Calm

GREEN PARK IS A THOUGHTFULLY DESIGNED RESIDENTIAL COMMUNITY THAT BLENDS MODERN LIVING WITH THE TRANQUILITY OF NATURE. SURROUNDED BY LUSH GREEN LANDSCAPES AND OPEN SPACES, IT OFFERS A REFRESHING ESCAPE FROM CITY CHAOS WHILE KEEPING YOU CONNECTED TO URBAN CONVENIENCES. EACH HOME IS CRAFTED FOR COMFORT, STYLE, AND SUSTAINABILITY, FEATURING QUALITY CONSTRUCTION AND SMART LAYOUTS. WITH PREMIUM AMENITIES, SECURE SURROUNDINGS, AND EXCELLENT CONNECTIVITY TO SCHOOLS, HOSPITALS, AND BUSINESS HUBS, GREEN PARK ENSURES A LIFESTYLE OF EASE AND ELEGANCE. IT'S NOT JUST A PLACE TO LIVE—IT'S A SPACE WHERE LIFE GROWS NATURALLY IN HARMONY WITH NATURE.

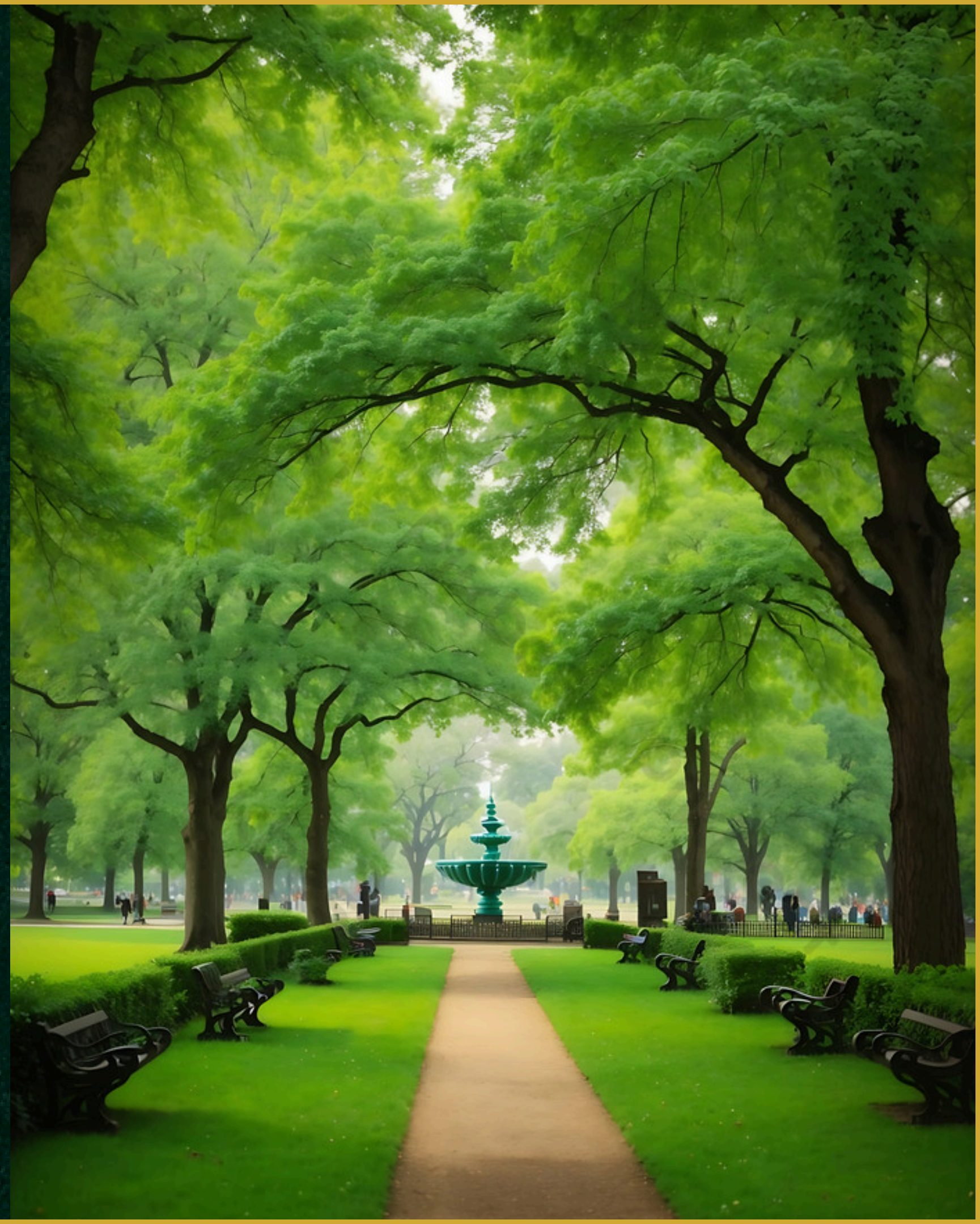

SWIMMING POOL

Where Every Splash Reflects Elegance

AT LUMAC, WE BELIEVE LUXURY LIVING GOES BEYOND WALLS — IT FLOWS INTO EVERY EXPERIENCE. OUR PREMIUM SWIMMING POOL IS DESIGNED TO BRING RELAXATION, WELLNESS, AND SOPHISTICATION TOGETHER. SURROUNDED BY SERENE LANDSCAPES AND MODERN AESTHETICS, IT OFFERS THE PERFECT RETREAT TO UNWIND AND REFRESH YOUR SENSES. WHETHER IT'S AN ENERGIZING MORNING SWIM OR A CALMING EVENING DIP, THE TRANQUIL WATERS INVITE YOU TO EMBRACE PEACE AND LEISURE. WITH EVERY DETAIL CRAFTED FOR COMFORT AND CLASS, THE LUMAC SWIMMING POOL IS MORE THAN AN AMENITY — IT'S A LIFESTYLE STATEMENT THAT ELEVATES EVERYDAY LIVING.



THANK YOU